

6756 Supply Way  
Boise, ID. 83716  
PH # 208-345-3844  
Fax# 208-



5 Campbell Drive  
Hermiston, Or. 97838  
Toll Free 877-385-3125  
Local 541-564-7636  
Fax: 541-564-6522

**Flanges & Gaskets are part of our freight prepaid program/Free delivery area! See our Map!**

# Flange Catalogs

## Plate Class B, Class D, 150LB, 300LB



### ANSI CLASS 150 FLANGES

### 150 lb. Flange

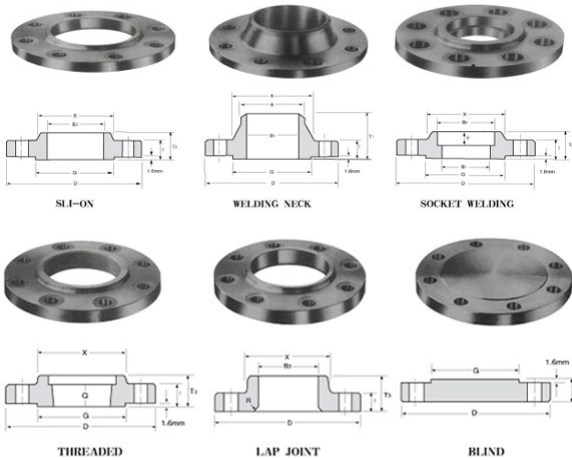

Material	Carbon steel			STAINLESS STEEL				
	Norm.	High	Low	Type 304	Type 316	Types 304L 316L	Type 321	Types 347 348
Temp. °F								
-20 to 100	285	290	235	275	275	230	275	275
200	260	260	215	235	240	195	235	245
300	230	230	210	205	215	175	210	225
400		200		180	195	160	190	200
500		170			170	145		170
600		140			140	140		140
650		125			125	125		125
700		110			110	110		110
750		95			95	95		95
800		80			80	80		80
850					65	65		65
900					50			50
950					35			35
1000					20			20

Pressure in Pounds per square inch, gage (psig)

**A-1 Industrial Supply is The Most Complete Supplier of Industrial Plumbing Products!**

<u>Hose Hydraulics</u>	<u>Hyd QC's</u>	<u>Camlocks</u>	<u>Valves: Ball,</u>
<u>Hose Fittings Hyd.</u>	<u>Hyd Swivel</u>	<u>Clamps 10 types</u>	<u>B.Fly, Gate Etc.</u>
<u>Adapters Hydraulic</u>	<u>Hose Industria</u>	<u>Fire Adapters</u>	<u>Pipe:</u>
<u>Flanges Hydraulic</u>	<u>Hose Ends</u>	<u>Water Cannons</u>	<u>Tubing:</u>
			<u>Pipe Fittngs</u>
			<u>Weld Fittings</u>
			<u>Water Truck"</u>
			<u>Parts &amp; Pumps</u>

# Flanges Steel

Items in this catalog are part of our Freight prepaid/Free delivery program! See freight program!

## Plate Class B, Class D, 150LB, 300LB



Note: In sizes 14" and larger O.D. and IPS are the same!



### Plate Flanges 1/2 IPS Pipe (1/2 Thick) 125lb. Note! All sizes rated for 200wpsi for water.

Part #	Nom.	I.D.	B.C.	# Holes	Bolt	lbs	thickness	weight
FL-1/2-PL-IPS-2	2"	2.44	4 3/4	4	5/8	3.50	0.50	1.44
FL-1/2-PL-IPS-2.5	2 1/2"	2.94	5 1/2	4	5/8	4.50	0.50	1.96
FL-1/2-PL-IPS-3"	3"	3.57	6	4	5/8	4.70	0.50	2.12
FL-1/2-PL-IPS-4"	4"	4.57	7 1/2	8	5/8	6.40	0.50	2.88
FL-1/2-PL-IPS-5"	5"	5.66	8 1/2	8	3/4	7.20	0.50	3.21
FL-1/2-PL-IPS-6"	6"	6.72	9 1/2	8	3/4	8.40	0.50	3.61
FL-1/2-PL-IPS-8"	8"	8.72	11 3/4	8	3/4	11.40	0.50	5.14
FL-1/2-PL-IPS-10"	10"	10.88	11 3/4	12	7/8	16.30	0.50	6.49
FL-1/2-PL-IPS-12"	12"	12.88	17	12	7/8	21.60	0.50	9.40

Note: In sizes 14" and larger O.D. and IPS are the same!



### Plate Flanges 1/2" O.D. (1/2 thick 2" thru 12", 5/8" 14" & 16", 3/4" 18 thru 24") 125lb. Note! 12" & under rated for 200wpsi.

Part #	Nom.	I.D.	B.C.	# Holes	Bolt	lbs	thickness	weight
FL1/2-PL-OD-2.06-2	2"	2.06	4 3/4	4	5/8	3.50	0.50	1.53
FL1/2-PL-OD--2.506-2.5	2 1/2"	2.56	5 1/2	4	5/8	4.50	0.50	2.07
FL1/2-PL-OD-3.06-3	3"	3.06	6	4	5/8	5.30	0.50	2.29
FL1/2-PL-OD-4.06-4	4"	4.06	7 1/2	8	5/8	6.90	0.50	3.10
FL1/2-PL-OD-5.06-5	5"	5.06	8 1/2	8	3/4	8.00	0.50	3.53
FL1/2-PL-OD-6.06-6	6"	6.06	9 1/2	8	3/4	9.00	0.50	4.03
FL1/2-PL-OD-8.06-8	8"	8.06	11 3/4	8	3/4	12.60	0.50	5.70
FL1/2-PL-OD-10.06-10	10"	10.06	11 3/4	12	7/8	16.30	0.50	7.36
FL1/2-PL-OD-12.06-12	12"	12.06	17	12	7/8	22.50	0.50	10.43
FL1/2-PL-OD.-14.19-14	14"	14.14					0.625	
FL1/2-PL-OD.-16.19-16	16"	16.19	21 1/4	16	1		0.625	17.32
FL1/2-PL-OD-18.19-18	18"	18.19	23	16	1 1/8		0.70	19.38
FL3/4-PL-OD-20.19-20	20"	20.19					0.70	
FL3/4-PL-OD-24.19-24	24"	24.19					0.75	

Note: In sizes 14" and larger O.D. and IPS are the same!



**Blind Plate Flanges (1/2 thick 2" thru 12", 5/8" 14" & 16" & 3/4" 18 thru 24")**

Part #	Nom.	I.D.	B.C.	# Holes	Bolt	lbs	thickness	weight
FL-1/2-PL-B.-2	2"	Blind	4 3/4	4	5/8		0.50	1.74
FL-1/2-PL-B.-2.5	2 1/2"	Blind	5 1/2	4	5/8		0.50	2.40
FL-1/2-PL-B.-3	3"	Blind	6	4	5/8	6.50	0.50	2.76
FL-1/2-PL-B.-4	4"	Blind	7 1/2	8	5/8	9.00	0.50	3.94
FL-1/2-PL-B.-5								
FL-1/2-PL-B.-6	6"	Blind	9 1/2	8	3/4	13.50	0.50	5.89
FL-1/2-PL-B.-8	8"	Blind	11 3/4	8	3/4	21.00	0.50	8.99
FL-1/2-PL-B.-10	10"	Blind	11 3/4	12	7/8	27.80	0.50	12.48
FL-1/2-PL-B.-12	12"	Blind	17	12	7/8	41.80	0.50	17.79
FL-1/2-PL-B.-14	14"	Blind					0.625	
FL-1/2-PL-B.-16	16"	Blind	21 1/4	16	1	60.80	0.625	33.89
FL-1/2-PL-B.-18	18"	Blind	23	16	1 1/8	65.20	0.70	42.80
FL-1/2-PL-B.-20	20"	Blind					0.70	
FL-1/2-PL-B.-24	24"	Blind	25	20	1 1/8	81.20	0.75	75.73
FL-1/2-PL-B.-30	30"	Blind						
FL-1/2-PL-B.-36	36"	Blind						



**Yes! We can make 12" Flange x MPT**  
**We can make Lgths as long 21' up to 6"MPT**



Flanges are welded inside and out! Plus 2 holed

**Plate Flanges 1/2 By Male Pipe (1/2 Thick) 125lb. Note! All sizes rated for 200wpsi for water.**

Part #	2" Long	2 1/2" Long	3" Long	4" Long	6" Long	8" Long	10" Long
FLMPT1/2-2x2- L							
FLMPT1/2-2x1.5- L							
FLMPT1/2-2.5x2.5- L							
FLMPT1/2-2.5x2- L							
FLMPT1/2-3x3- L							
FLMPT1/2-3-2.5- L							
FLMPT1/2-3x2- L							
FLMPT1/2-4x4- L							
FLMPT1/2-4x3- L							
FLMPT1/2-4x2.5- L							
FLMPT1/2-4x2- L							
FLMPT1/2-5x5- L							
FLMPT1/2-5x4- L							
FLMPT1/2-6x6- L							
FLMPT1/2-6x4- L							
FLMPT1/2-6x3- L							
FLMPT1/2-8x8- L							
FLMPT1/2-8x6- L							
FLMPT1/2-8x5- L							
FLMPT1/2-8x4- L							
FLMPT1/2-10x10- L							
FLMPT1/2-10x8- L							
FLMPT1/2-10x6- L							
FLMPT1/2-10x4- L							
FLMPT1/2-12x12- L							
FLMPT1/2-12x10- L							
FLMPT1/2-12x8- L							
FLMPT1/2-12x6- L							



Note: In sizes 14" and larger O.D. and IPS are the same!



**AWWA Class D Flanges IPS**

Part #	Nom.	I.D.	B.C.	# Holes	Bolt	lbs	thickness	weight
FL-CD-PL-IPS-2	2"	2.44	4 3/4	4	5/8	3.50	0.625	1.800
FL-CD-PL-IPS-2.5	2 1/2"	2.94	5 1/2	4	5/8	4.50	0.625	2.450
FL-CD-PL-IPS-3	3"	3.57	6	4	5/8	4.70	0.625	2.650
FL-CD-PL-IPS-4	4"	4.57	7 1/2	8	5/8	6.40	0.625	3.600
FL-CD-PL-IPS-5	5"	5.66	8 1/2	8	3/4	7.20	0.625	4.010
FL-CD-PL-IPS-6	6"	6.72	9 1/2	8	3/4	8.40	0.688	4.960
FL-CD-PL-IPS-8	8"	8.72	11 3/4	8	3/4	11.40	0.688	7.080
FL-CD-PL-IPS-10	10"	10.88	11 3/4	12	7/8	16.30	0.688	8.930
FL-CD-PL-IPS-12	12"	12.88	17	12	7/8	21.60	0.813	15.28

Note: In sizes 14" and larger O.D. and IPS are the same!



**AWWA Class D Flanges O.D. Note:**

Part #	Nom.	I.D.	B.C.	# Holes	Bolt	lbs	thickness	weight
FL-CD-PL-OD-8	8"							
FL-CD-PL-OD-10	10"							
FL-CD-PL-OD-12	12"							
FL-CD-PL-OD-14	14"						0.938	
FL-CD-PL-OD-16	16"	16.13	21 1/4	16	1	60.80	1.000	27.91
FL-CD-PL-OD-18	18"	18.13	23	16	1 1/8	65.20	1.063	29.67
FL-CD-PL-OD-20	20"	20.13	25	20	1 1/8	81.20	1.125	37.05
FL-CD-PL-OD-24	24"	24.13	29 1/2	20	1 1/4	112.0	1.250	51.88
FL-CD-PL-OD-30	30"						1.375	
FL-CD-PL-OD-36	36"	36.19	42 3/4	32	1 5/8	265.0	1.625	118.5
FL-CD-PL-OD-42	42"						1.750	
FL-CD-PL-OD-48	48"						1.875	

Note: In sizes 14" and larger O.D. and IPS are the same!



**AWWA Class D Blind Flanges: 1986 spec. Now = current Class B Spec.**

Part #	Nom.	I.D.	B.C.	# Holes	Bolt	lbs	thickness	weight
FL-CD-PL-B-2								
FL-CD-PL-B-2.5								
FL-CD-PL-B-3	3"	blank					0.625	
FL-CD-PL-B-4	4"	blank	7 1/2	8	5/8	8.10	0.625	4.9
FL-CD-PL-B-5							0.625	
FL-CD-PL-B-6	6"	blank	9 1/2	8	3/4	10.70	0.688	8.1
FL-CD-PL-B-8	8"	blank	11 3/4	8	3/4	15.70	0.688	12.4
FL-CD-PL-B-10	10"	blank	11 3/4	12	7/8	19.30	0.688	17.2
FL-CD-PL-B-12	12"	blank	17	12	7/8	33.90	0.719	25.6
FL-CD-PL-B-14	14"	blank					0.791	
FL-CD-PL-B-16	16"	blank	21 1/4	16	1	60.80	0.892	48.4
FL-CD-PL-B-18	18"	blank	23	16	1 1/8	65.20	0.950	58.1
FL-CD-PL-B-20	20"	blank	25	20	1 1/8	81.20	1.040	76.9
FL-CD-PL-B-24	24"	blank	29 1/2	20	1 1/4	112.0	1.216	122.1
FL-CD-PL-B-30	30"	blank					1.477	
FL-CD-PL-B-36	36"	blank	42 3/4	32	1 5/8	265.0	1.751	359.6
FL-CD-PL-B-42	42"	blank					2.023	
FL-CD-PL-B-48	48"	blank					2.559	

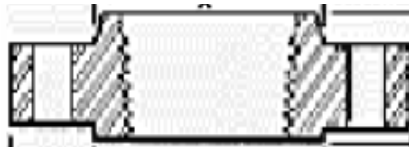

**Companion Flanges**

**ANSI B16.5 150# Carbon Steel Forged Threaded NPT Raised-Face Flange**

Part #	Nom.	O.D.	Bolt Circle	# Holes	Bolt holes	Thickness	weight		
FL150-NPT-RF-3/4CS	3/4"	3.88	2.75	4	1/2	0.44	0.58		
FL150-NPT-RF-1CS	1"	4.25	3.12	4	1/2	0.50	0.80		
FL150-NPT-RF-1.25CS	1 1/4"	4.62	3.50	4	1/2	0.56	1.07		
FL150-NPT-RF-1.5CS	1 1/2"	5.00	3.88	4	1/2	0.62	1.37		
FL150-NPT-RF-2CS	2"	6.00	4.75	4	5/8	0.69	2.21		
FL150-NPT-RF-2.5CS	2 1/2"	7.00	5.50	4	5/8	0.81	3.32		
FL150-NPT-RF-3CS	3"	7.50	6.00	4	5/8	0.88	3.83		
FL150-NPT-RF-4CS	4"	9.00	7.50	8	5/8	0.88	5.40		
FL150-NPT-RF-5CS	5"	10.00	8.50	8	3/4	0.88	6.26		
FL150-NPT-RF-6CS	6"	11.00	9.50	8	3/4	0.94	7.50		
FL150-NPT-RF-8CS	8"	13.50	11.75	8	3/4	1.06	12.30		
FL150-NPT-RF-10CS	10"	16.00	14.25	12	7/8	1.12	17.10		
FL150-NPT-RF-12CS	12"	19.00	17.00	12	7/8	1.19	26.50		



RAISED FACE

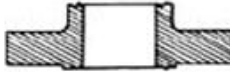

**ANSI B16.5 150# CARBON STEEL SLIP-ON RAISED-FACE FLANGE**

Part #	Nom.	O.D.	Bolt Circle	# Holes	Bolt holes	Thickness	weight		
FL150-SLP-RF-3/4CS	3/4"	3.88	2.75	4	1/2	0.44	0.58		
FL150-SLP-RF-1CS	1"	4.25	3.12	4	1/2	0.50	0.80		
FL150-SLP-RF-1.25CS	1 1/4"	4.62	3.50	4	1/2	0.56	1.07		
FL150-SLP-RF-1.5CS	1 1/2"	5.00	3.88	4	1/2	0.62	1.37		
FL150-SLP-RF-2CS	2"	6.00	4.75	4	5/8	0.69	2.21		
FL150-SLP-RF-2.5CS	2 1/2"	7.00	5.50	4	5/8	0.81	3.32		
FL150-SLP-RF-3CS	3"	7.50	6.00	4	5/8	0.88	3.83		
FL150-SLP-RF-4CS	4"	9.00	7.50	8	5/8	0.88	5.40		
FL150-SLP-RF-5CS	5"	10.00	8.50	8	3/4	0.88	6.26		
FL150-SLP-RF-6CS	6"	11.00	9.50	8	3/4	0.94	7.50		
FL150-SLP-RF-8CS	8"	13.50	11.75	8	3/4	1.06	12.30		
FL150-SLP-RF-10CS	10"	16.00	14.25	12	7/8	1.12	17.10		
FL150-SLP-RF-12CS	12"	19.00	17.00	12	7/8	1.19	26.50		
FL150-SLP-RF-14CS	14"		21 1/4	16	1	1.31	34.50		
FL150-SLP-RF-16CS	16"		23	16	1 1/8	1.38	45.50		
FL150-SLP-RF-18CS	18"		25	20	1 1/8	1.50	48.50		
FL150-SLP-RF-20CS	20"		29 1/2	20	1 1/4	1.6	61.80		
FL150-SLP-RF-24CS	24"		42 3/4	32	1 5/8	1.8	87.70		
FL150-SLP-RF-30CS	30"								
FL150-SLP-RF-36CS	36"								
FL150-SLP-RF-42CS	42"								

FL150-SLP-RF-R3x2CS	3"	7.50	6.00	4	5/8	0.88			
FL150-SLP-RF-R3x2.5CS	3"	7.50	6.00	4	5/8	0.88			
FL150-SLP-RF-R4x2CS	4"	9.00	7.50	8	5/8	0.88			
FL150-SLP-RF-4x2.5CS	4"	9.00	7.50	8	5/8	0.88			
FL150-SLP-RF-4x3CS	4"	9.00	7.50	8	5/8	0.88			
FL150-SLP-RF-6x3CS	6"	11.00	9.50	8	3/4	0.94			
FL150-SLP-RF-6x4CS	6"	11.00	9.50	8	3/4	0.94			
FL150-SLP-RF-8x4CS	8"	13.50	11.75	8	3/4	1.06			
FL150-SLP-RF-8x6CS	8"	13.50	11.75	8	3/4	1.06			

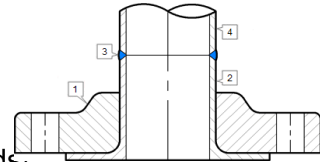

ANSI B16.5 150# CARBON STEEL LAP JOINT FLANGE use with Stub ends:

Part #	Nom.	O.D.	Bolt Circle	# Holes	Bolt	Thickness	weight		
FL150-LJ-1.5CS	1.5"								
FL150-LJ-2CS	2"	6.00	4.75	4	5/8	0.69	2.21		
FL150-LJ-2.5CS	2 1/2"	7.00	5.50	4	5/8	0.81	3.34		
FL150-LJ-3CS	3"	7.50	6.00	4	5/8	0.88	3.83		
FL150-LJ-4CS	4"	9.00	7.50	8	5/8	0.88	5.40		
FL150-LJ-5CS	5"	10.00	8.50	8	3/4	0.88	6.26		
FL150-LJ-6CS	6"	11.00	9.50	8	3/4	0.94	7.50		



FLAT FACE

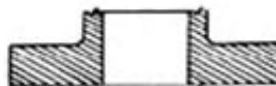

ANSI B16.5 150# CARBON STEEL SLIP-ON FULL-FACE FLANGE

Part #	Nom.	O.D.	Bolt Circle	# Holes	Bolt holes	Thickness	weight		
FL150-SLP-FF-3/4CS	3/4"	3.88	2.75	4	1/2	0.44	0.58		
FL150-SLP-FF-1CS	1"	4.25	3.12	4	1/2	0.50	0.80		
FL150-SLP-FF-1.25CS	1 1/4"	4.62	3.50	4	1/2	0.56	1.07		
FL150-SLP-FF-1.5CS	1 1/2"	5.00	3.88	4	1/2	0.62	1.37		
FL150-SLP-FF-2CS	2"	6.00	4.75	4	5/8	0.69	2.21		
FL150-SLP-FF-2.5CS	2 1/2"	7.00	5.50	4	5/8	0.81	3.32		
FL150-SLP-FF-3CS	3"	7.50	6.00	4	5/8	0.88	3.83		
FL150-SLP-FF-4CS	4"	9.00	7.50	8	5/8	0.88	5.40		
FL150-SLP-FF-5CS	5"	10.00	8.50	8	3/4	0.88	6.26		
FL150-SLP-FF-6CS	6"	11.00	9.50	8	3/4	0.94	7.50		
FL150-SLP-FF-8CS	8"	13.50	11.75	8	3/4	1.06	12.30		
FL150-SLP-FF-10CS	10"	16.00	14.25	12	7/8	1.12	17.10		
FL150-SLP-FF-12CS	12"	19.00	17.00	12	7/8	1.19	26.50		

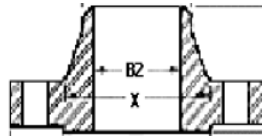

**ANSI B16.5 150# CARBON STEEL WELD NECK RAISED-FACE FLANGE**

Part #	Nom.	O.D.	Bolt Circle	# Holes	Bolt holes	Thickness	weight		
FL150-WN-RF-1.5CS	1.5"								
FL150-WN-RF-2CS	2"	6.00	4.75	4	5/8	0.69	2.72		
FL150-WN-RF-2.5CS	2 1/2"	7.00	5.50	4	5/8	0.81	4.45		
FL-150-WN-RF-3CS	3"	7.50	6.00	4	5/8	0.88	5.22		
FL150-WN-RF-4CS	4"	9.00	7.50	8	5/8	0.88	7.49		
FL150-WN-RF-5CS	5"	10.00	8.50	8	3/4	0.88	9.53		
FL150-WN-RF-6CS	6"	11.00	9.50	8	3/4	0.94	11.80		
FL150-WN-RF-8CS	8"	13.50	11.75	8	3/4	1.06	19.10		
FL150-WN-RF-10CS	10"	16.00	14.25	12	7/8	1.12	24.50		
FL150-WN-RF-12CS	12"	19.00	17.00	12	7/8	1.19	39.90		
FL150-WN-RF-14CS	14"								
FL150-WN-RF-16CS	16"								
FL150-WN-RF-18CS	18"								



**ANSI B16.5 150# CARBON STEEL SLIP-ON RAISED-FACE FLANGE**

Part #	Nom.	O.D.	Bolt Circle	# Holes	Bolt holes	Thickness	weight		
FL150-BL-RF-3/4CS	3/4"	3.88	2.75	4	1/2	0.44	0.63		
FL150-BL-RF-1CS	1"	4.25	3.12	4	1/2	0.50	0.89		
FL150-BL-RF-1.25CS	1 1/4"	4.62	3.50	4	1/2	0.56	1.20		
FL150-BL-RF-1.5CS	1 1/2"	5.00	3.88	4	1/2	0.62	1.58		
FL150-BL-RF-2CS	2"	6.00	4.75	4	5/8	0.69	2.39		
FL150-BL-RF-2.5CS	2 1/2"	7.00	5.50	4	5/8	0.81	4.07		
FL150-BL-RF-3CS	3"	7.50	6.00	4	5/8	0.88	4.92		
FL150-BL-RF-4CS	4"	9.00	7.50	8	5/8	0.88	7.13		
FL150-BL-RF-5CS	5"	10.00	8.50	8	3/4	0.88	8.72		
FL150-BL-RF-6CS	6"	11.00	9.50	8	3/4	0.94	11.40		
FL150-BL-RF-8CS	8"	13.50	11.75	8	3/4	1.06	20.10		
FL150-BL-RF-10CS	10"	16.00	14.25	12	7/8	1.12	28.70		
FL150-BL-RF-12CS	12"	19.00	17.00	12	7/8	1.19	43.80		
FL150-BL-RF-14CS	14"	16.13	21 1/4	16	1	1.31	58.20		
FL150-BL-RF-16CS	16"	18.13	23	16	1 1/8	1.38	77.40		
FL150-BL-RF-18CS	18"	20.13	25	20	1 1/8	1.50	94.00		
FL150-BL-RF-20CS	20"	24.13	29 1/2	20	1 1/4	1.6	122.70		
FL150-BL-RF-24CS	24"	36.19	42 3/4	32	1 5/8	1.8	187.00		



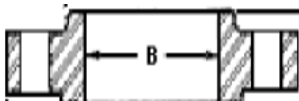

**ANSI B16.5 300# CARBON STEEL SLIP-ON RAISED-FACE FLANGE**

Part #	Nom.	O.D.	Bolt Circle	# Holes	Bolt holes	Thickness	weight		
FL300-SLP-RF-3/4CS	3/4"	4.62	3.25	4	5/8	0.56	1.16		
FL300-SLP-RF-1CS	1"	4.88	3.50	4	5/8	0.62	1.37		
FL300-SLP-RF-1.25CS	1 1/4"	5.25	3.88	4	5/8	0.69	1.75		
FL300-SLP-RF-1.5CS	1 1/2"	6.12	4.50	4	3/4	0.75	2.47		
FL300-SLP-RF-2CS	2"	6.50	5.00	8	3/4	0.81	2.90		
FL300-SLP-RF-2.5CS	2 1/2"	7.50	5.88	8	3/4	0.94	4.17		
FL300-SLP-RF-3CS	3"	8.25	6.62	8	3/4	1.06	5.92		
FL300-SLP-RF-4CS	4"	10.00	7.88	8	3/4	1.19	9.73		
FL300-SLP-RF-5CS	5"	11.00	9.25	8	3/4	1.31	12.10		
FL300-SLP-RF-6CS	6"	12.50	10.62	12	3/4	1.38	16.00		
FL300-SLP-RF-8CS	8"	15.00	13.00	12	7/8	1.56	23.90		
FL300-SLP-RF-10CS	10"	17.50	15.25	16	1	1.81	34.00		
FL300-SLP-RF-12CS	12"	20.50	17.75	16	1 1/8	1.94	49.10		

**ANSI B16.5 300# CARBON STEEL LAP JOINT FLANGE use with Stub ends!**

Part #	Nom.	O.D.	Bolt Circle	# Holes	Bolt	Thickness		
FL300-LJ-1.5CS	1 1/2"	6.12	4.50	4	3/4	0.75		
FL300-LJ-2CS	2"	6.50	5.00	8	3/4	0.81		
FL300-LJ-2.5CS	2 1/2"	7.50	5.88	8	3/4	0.94		
FL300-LJ-3CS	3"	8.25	6.62	8	3/4	1.06		
FL300-LJ-4CS	4"	10.00	7.88	8	3/4	1.19		
FL300-LJ-5CS	5"	11.00	9.25	8	3/4	1.31		
FL300-LJ-6CS	6"	12.50	10.62	12	3/4	1.38		

Items in this catalog are part of our Freight prepaid/Free delivery program! See freight program!

# Flanges Aluminum



## ANSI B16.5 150# Aluminum 356T6 Threaded NPT Flat-Face Flange

Part #	Nom.	I.D.	B.C.	# Holes	Bolt	lbs			
FL-150-NPT-FF-.50AL	1/2"			4					
FL-150-NPT-FF-.75AL	3/4"			4					
FL-150-NPT-FF-1AL	1"			4					
FL-150-NPT-FF-1.25AL	1 1/4"			4					
FL-150-NPT-FF-1.5AL	1 1/2"			4					
FL-150-NPT-FF-2AL	2"		4 3/4	4	5/8				
FL-150-NPT-FF-2.5AL	2 1/2"		5 1/2	4	5/8				
FL-150-NPT-FF-3AL	3"		6	4	5/8				
FL-150-NPT-FF-4AL	4"		7 1/2	8	5/8				
FL-150-NPT-FF-5AL	5"		8 1/2	8	3/4				
FL-150-NPT-FF-6AL	6"		9 1/2	8	3/4				
FL-150-NPT-FF-8AL	8"		11 3/4	8	3/4				



## ANSI B16.5 150# ALUMINUM 356T6 IPS SIZED SLIP-ON FLAT-FACE FLANGE

Part #	Nom.	I.D.	B.C.	# Holes	Bolt	lbs			
FL-150-SLP-FF-.5AL	1/2"			4					
FL-150-SLP-FF-.75AL	3/4"			4					
FL-150-SLP-FF-1AL	1"			4					
FL-150-SLP-FF-1.25AL	1 1/4"			4					
FL-150-SLP-FF-1.5AL	1 1/2"			4					
FL-150-SLP-FF-2AL	2"		4 3/4	4	5/8				
FL-150-SLP-FF-2.5AL	2 1/2"		5 1/2	4	5/8				
FL-150-SLP-FF-3AL	3"		6	4	5/8				
FL-150-SLP-FF-4AL	4"		7 1/2	8	5/8				
FL-150-SLP-FF-5AL	5"		8 1/2	8	3/4				
FL-150-SLP-FF-6AL	6"		9 1/2	8	3/4				
FL-150-SLP-FF-8AL	8"		11 3/4	8	3/4				
FL-150-SLP-FF-10AL	10"		11 3/4	12	7/8				
FL-150-SLP-FF-12AL	12"		17	12	7/8				



**ANSI B16.5 150# ALUMINUM 356T6 O.D. SIZED SLIP-ON FLAT-FACE FLANGE FOR TUBING**

Part #	Nom.	I.D.	B.C.	# Holes	Bolt	lbs			
FL-150-SLP-OD-FF-2AL	2"		4 3/4	4	5/8				
FL-150-SLP-OD-FF-2.5AL	2 1/2"		5 1/2	4	5/8				
FL-150-SLP-OD-FF-3AL	3"		6	4	5/8				
FL-150-SLP-OD-FF-4AL	4"		7 1/2	8	5/8				
FL-150-SLP-OD-FF-6AL	6"		9 1/2	8	3/4				
FL-150-SLP-OD-FF-8AL	8"		11 3/4	8	3/4				
FL-150-SLP-OD-FF-10AL	10"		11 3/4	12	7/8				
FL-150-SLP-OD-FF-12AL	12"		17	12	7/8				



**ANSI B16.5 150# ALUMINUM BLIND FLAT-FACE FLANGE**

Part #	Nom.	I.D.	B.C.	# Holes	Bolt	lbs			
FL-150-BL-FF-.50AL	1/2"			4					
FL-150-BL-FF-.75AL	3/4"			4					
FL-150-BL-FF-1AL	1"			4					
FL-150-BL-FF-1.25	1 1/4"			4					
FL-150-BL-FF-1.50AL	1 1/2"			4					
FL-150-BL-FF-2AL	2"		4 3/4	4	5/8				
FL-150-BL-FF-2.5AL	2 1/2"		5 1/2	4	5/8				
FL-150-BL-FF-3AL	3"		6	4	5/8				
FL-150-BL-FF-4AL	4"		7 1/2	8	5/8				
FL-150-BL-FF-5AL	5"		8 1/2	8	3/4				
FL-150-BL-FF-6AL	6"		9 1/2	8	3/4				
FL-150-BL-FF-8AL	8"		11 3/4	8	3/4				
FL-150-BL-FF-10AL	10"		11 3/4	12	7/8				
FL-150-BL-FF-12AL	12"		17	12	7/8				



**ANSI B16.5 150# ALUMINUM WELD NECK FLAT-FACE FLANGE**

Part #	Nom.	I.D.	B.C.	# Holes	Bolt	lbs			
FL-150-WN-FF-.50AL	1/2"			4					
FL-150-WN-FF-.75AL	3/4"			4					
FL-150-WN-FF-1AL	1"			4					
FL-150-WN-FF-1.25AL	1 1/4"			4					
FL-150-WN-FF-1.50AL	1 1/2"			4					
FL-150-WN-FF-2AL	2"		4 3/4	4	5/8				
FL-150-WN-FF-2.5AL	2 1/2"		5 1/2	4	5/8				
FL-150-WN-FF-3AL	3"		6	4	5/8				
FL-150-WN-FF-4AL	4"		7 1/2	8	5/8				
FL-150-WN-FF-5	5"		8 1/2	8	3/4				
FL-150-WN-FF-6AL	6"		9 1/2	8	3/4				
FL-150-WN-FF-8AL	8"		11 3/4	8	3/4				
FL-150-WN-FF-10AL	10"		11 3/4	12	7/8				
FL-150-WN-FF-12AL	12"		17	12	7/8				

Items in this catalog are part of our Freight prepaid/Free delivery program! See freight program!

# Flanges Stainless Steel

**SS304/SS316 Plate Flanges 1/2 thick IPS Pipe 125lb. Note! All sizes rated for 200wpsi for water.**

Part #	Nom.	I.D.	B.C.	# Holes	Bolt	lbs		SS304	SS316
FL-1/2-PL-IPS-2-S4/orS6	2"	2.44	4 3/4	4	5/8				
FL-1/2-PL-IPS-2.5-S4/orS6	2 1/2"	2.94	5 1/2	4	5/8				
FL-1/2-PL-IPS-3-S4/orS6	3"	3.57	6	4	5/8				
FL-1/2-PL-IPS-4-S4/orS6	4"	4.57	7 1/2	8	5/8				
FL-1/2-PL-IPS-5-S4/orS6	5"	5.66	8 1/2	8	3/4				
FL-1/2-PL-IPS-6-S4/orS6	6"	6.72	9 1/2	8	3/4				
FL-1/2-PL-IPS-8-S4/orS6	8"	8.72	11 3/4	8	3/4				
FL-1/2-PL-IPS-10-S4/orS6	10"	10.88	11 3/4	12	7/8				
FL-1/2-PL-IPS-12-S4/orS6	12"	12.88	17	12	7/8				

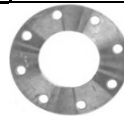

**SS304/SS316 Plate Flanges 1/2" O.D. (1/2 Thick) Note! All sizes rated for 200wpsi for water.**

Part #	Nom.	I.D.	B.C.	# Holes	Bolt	lbs		SS304	SS316
FL-1/2-PL-OD-2-S4orS6	2"	2.06	4 3/4	4	5/8	3.50			
FL-1/2-PL-OD-2.5-S4orS6	2 1/2"	2.56	5 1/2	4	5/8	4.50			
FL-1/2-PL-OD-3-S4orS6"	3"	3.06	6	4	5/8	5.30			
FL-1/2-PL-OD-4-S4orS6"	4"	4.06	7 1/2	8	5/8	6.90			
FL-1/2-PL-OD-5-S4orS6"	5"	5.06	8 1/2	8	3/4	8.00			
FL-1/2-PL-OD-6-S4orS6	6"	6.06	9 1/2	8	3/4	9.00			
FL-1/2-PL-OD-8-S4orS6	8"	8.06	11 3/4	8	3/4	12.60			
FL-1/2-PL-OD-10-S4orS6	10"	10.06	11 3/4	12	7/8	16.30			
FL-1/2-PL-OD-12-S4orS6	12"	12.06	17	12	7/8	22.50			
FL-5/8-PL-OD-14-S4orS6	14"	14.06							
FL-5/8-PL-OD-16-S4orS6	16"	16.13	21 1/4	16	1				

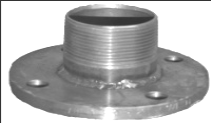

Flanges are welded inside and out! Plus 2 holed clocked!

**SS304/SS316 Plate Flanges 1/2 By Male Pipe (1/2 Thick) 200wpsi**

Part #	Nom.	Stan	lgth	SS304	SS316	SS304	SS316	SS304	SS316
				Stan.lgth	Stan.lgth	6" long	6" long	12" long	12" long
FL-1/2-MPT-2x1.5-S4orS6	2"	2"							
FL-1/2-MPT-2x2-S4orS6	2"	2"							
FL-1/2-MPT-2.5x2-S4orS6	2 1/2"	2"							
FL-1/2-MPT-2.5x2.5-S4orS6	2 1/2"	2"							
FL-1/2-MPT-3x1.5-S4orS6	3"	3"							
FL-1/2-MPT-3x2-S4orS6	3"	2"							
FL-1/2-MPT-3x2.5-S4orS6	3"	2"							
FL-1/2-MPT-3x3-S4orS6	3"	3"							
FL-1/2-MPT-4x2-S4orS6	4"	2"							
FL-1/2-MPT-4x2.5-S4orS6	4"	2"							
FL-1/2-MPT-4x3-S4orS6	4"	3"							
FL-1/2-MPT-4x4-S4orS6	4"	3"							
FL-1/2-MPT-5x5-S4orS6	5"	3"							
FL-1/2-MPT-6x2-S4orS6	6"	2"							
FL-1/2-MPT-6x2.5-S4orS6	6"	2"							
FL-1/2-MPT-6x3-S4orS6	6"	3"							
FL-1/2-MPT-6x4-S4orS6	6"	3"							
FL-1/2-MPT-6x5-S4orS6	6"	3"							
FL-1/2-MPT-6x6-S4orS6	6"	3"							



**SS304/SS316 Blind Plate Flanges (1/2 thick)**

Part #	Nom.	I.D.	B.C.	# Holes	Bolt	lbs		SS304	SS316
FL-1/2-PL-B.-2-S4orS6	2"	Blind	4 3/4	4	5/8				
FL-1/2-PL-B.-2.5-S4orS6	2 1/2"	Blind	5 1/2	4	5/8				
FL-1/2-PL-B.-3-S4orS6	3"	Blind	6	4	5/8	6.50			
FL-1/2-PL-B.-4-S4orS6	4"	Blind	7 1/2	8	5/8	9.00			
FL-1/2-PL-B.-6-S4orS6	6"	Blind	9 1/2	8	3/4	13.50			
FL-1/2-PL-B.-8S-4orS6	8"	Blind	11 3/4	8	3/4	21.00			
FL-1/2-PL-B.-10-S4orS6	10"	Blind	11 3/4	12	7/8	27.80			
FL-1/2-PL-B.-12-S4orS6	12"	Blind	17	12	7/8	41.80			
FL-CD-PL-B.-14-S4orS6	14"	Blind							
FL-CD-PL-B.-16-S4orS6	16"	Blind	21 1/4	16	1	60.80			
FL-CD-PL-B.-18-S4orS6	18"	Blind	23	16	1 1/8	65.20			
FL-CD-PL-B.-2-4S4orS6	24"	Blind	25	20	1 1/8	81.20			

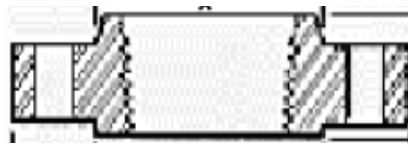

**SS304/316 ANSI B16.5 150# 304SS Forged Threaded NPT Raised-Face Flange**

Part #	Nom.	I.D.	B.C.	# Holes	Bolt	lbs		SS304	SS316
FL150SS-NPT-RF-.5-S4orS6	1/2"								
FL150SS-NPT-RF-.75-S4orS6	3/4"								
FL150SS-NPT-RF-1-S4orS6	1"								
FL150SS-NPT-RF-1.2-S4orS6	1 1/4"								
FL50SS-NPT-RF-1.5-S4orS6	1 1/2"								
FL150SS-NPT-RF-2-S4orS6	2"		4 3/4	4	5/8				
FL150SS-NPT-RF-2.5-S4orS6	2 1/2"		5 1/2	4	5/8				
FL150SS-NPT-RF-3-S4orS6	3"		6	4	5/8				
FL150SS-NPT-RF-4-S4orS6	4"		7 1/2	8	5/8				
FL150SS-NPT-RF-5-S4orS6	5"		8 1/2	8	3/4				
FL150SS-NPT-RF-6-S4orS6	6"		9 1/2	8	3/4				
FL150SS-NPT-RF-8-S4orS6	8"		11 3/4	8	3/4				
FL150SS-NPT-RF-10-S4orS6	10"		11 3/4	12	7/8				
FL150SS-NPT-RF-12-S4orS6	12"		17	12	7/8				

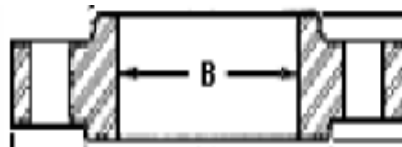

**ANSI B16.5 150# 304SS SLIP-ON RAISED-FACE FLANGE**

Part #	Nom.	I.D.	B.C.	# Holes	Bolt	lbs		SS304	SS316
FL150SS-SLP-RF.5-S4orS6									
FL150SS-SLP-RF-.75-S4orS6	3/4"								
FL150SS-SLP-RF-1-S4orS6	1"								
FL150SS-SLP-RF-1.2-S4orS6	1 1/4"								
FL150SS-SLP-RF-1.5-S4orS6	1 1/2"								
FL150SS-SLP-RF-2-S4orS6	2"		4 3/4	4	5/8				
FL150SS-SLP-RF-2.5-S4orS6	2 1/2"		5 1/2	4	5/8				
FL150SS-SLP-RF-3-S4orS6	3"		6	4	5/8				
FL150SS-SLP-RF-4-S4orS6	4"		7 1/2	8	5/8				
FL150SS-SLP-RF-5-S4orS6	5"		8 1/2	8	3/4				
FL150SS-SLP-RF-6-S4orS6	6"		9 1/2	8	3/4				
FL150SS-SLP-RF-8-S4orS6	8"		11 3/4	8	3/4				
FL150SS-SLP-RF-10-S4orS6	10"		11 3/4	12	7/8				
FL150SS-SLP-RF-12-S4orS6	12"		17	12	7/8				

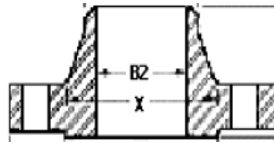

**ANSI B16.5 150# 304SS STEEL WELD NECK RAISED-FACE FLANGE**

Part #	Nom.	I.D.	B.C.	# Holes	Bolt	lbs		SS304	SS316
FL150SS-WN-RF-.5-S4orS6	1/2"								
FL150SS-WN-RF-3/4-S4orS6	3/4"								
FL150SS-WN-RF-1-S4orS6	1"								
FL150SS-WN-RF-1.2-S4orS6	1 1/4"								
FL150SS-WN-RF-1.5-S4orS6	1 1/2"								
FL150SS-WN-RF-2-S4orS6	2"		4 3/4	4	5/8				
FL150SS-WN-RF-2.5-S4orS6	2 1/2"		5 1/2	4	5/8				
FL150SS-WN-RF-3-S4orS6	3"		6	4	5/8				
FL150SS-WN-RF-4-S4orS6	4"		7 1/2	8	5/8				
FL150SS-WN-RF-5-S4orS6	5"		8 1/2	8	3/4				
FL150SS-WN-RF-6-S4orS6	6"		9 1/2	8	3/4				
FL150SS-WN-RF-8-S4orS6	8"		11 3/4	8	3/4				
FL150SS-WN-RF-10-S4orS6	10"		11 3/4	12	7/8				
FL150SS-WN-RF-12-S4orS6	12"		17	12	7/8				



**ANSI B16.5 150# 304SS STEEL BLIND FLANGE**

Part #	Nom.	I.D.	B.C.	# Holes	Bolt	lbs		SS304	SS316
FL150SS-BL-RF-.5-S4orS6	1/2"								
FL150SS-BL-RF-.75-S4orS6	3/4"								
FL150SS-BL-RF-1-S4orS6	1"								
FL150SS-BL-RF-1.2-S4orS6	1 1/4"								
FL150SS-BL-RF-1.5-S4orS6	1 1/2"								
FL150SS-BL-RF-2-S4orS6	2"		4 3/4	4	5/8				
FL150SS-BL-RF-2.5-S4orS6	2 1/2"		5 1/2	4	5/8				
FL150SS-BL-RF-3-S4orS6	3"		6	4	5/8				
FL150SS-BL-RF-4-S4orS6	4"		7 1/2	8	5/8				
FL150SS-BL-RF-5-S4orS6	5"		8 1/2	8	3/4				
FL150SS-BL-RF-6-S4orS6	6"		9 1/2	8	3/4				
FL150SS-BL-RF-8-S4orS6	8"		11 3/4	8	3/4				
FL150SS-BL-RF-10-S4orS6	10"		11 3/4	12	7/8				
FL150SS-BL-RF-12-S4orS6	12"		17	12	7/8				



Items in this catalog are part of our Freight prepaid/Free delivery program! See freight program!

# Flange Gaskets

Flange Gaskets Rubber, Non-Abestos 1/16 thick and 1/8 thick, Ring and Full faced



## Buna-N (Red Rubber Nitrile Gaskets) Full Face Flange Gasket 150lb 1/16"THK

PART#	SIZE	I.D.	O.D.	#Holes	Stock	lbs			
FFFLG-2"	2"	23/8"	6"	4	YES				
FFFLG-2 1/2"	2 1/2"	27/8"	7"	4	YES				
FFFLG-3"	3"	3 1/2"	7 1/2"	8	YES				
FFFLG-4"	4"	4 1/2"	9"	8	YES				
FFFLG-5"	5"	5 9/16"	10"	8	YES				
FFFLG-6"	6"	6 5/8"	11"	8	YES				
FFFLG-8"	8"	8 5/8"	13 1/2"	8	YES				
FFFLG-10"	10"	10 3/4"	16"	12	YES				
FFFLG-12"	12"	12 3/4"	19"	12	YES				
FFFLG-14"	14"	14"	21"	12	YES				
FFFLG-16"	16"	16"	23 1/2"	16	YES				
FFFLG-18"	18"	18"	25"	16	YES				
FFFLG-20"	20"	20"	27 1/2"	20	YES				
FFFLG-24"	24"	24"	32"	20	YES				
FFFLG-30"	30"	30"	38 3/4"	28	YES				
FFFLG-36"	36"	36"	46"	32	YES				
FFFLG-48"	48"	48"	59 1/2"	44	YES				



## Buna-N (Red Rubber Nitrile Gaskets) Ring Face Flange Gasket 150lb 1/16"THK (Drop in) for Weld on flanges

PART#	SIZE	I.D.	O.D.		Stock	lbs			
RFFLG-2"	2"	23/8"	4 1/8"		YES				
RFFLG-2 1/2"	2 1/2"	27/8"	4 7/8"		YES				
RFFLG-3"	3"	3 1/2"	5 3/8"		YES				
RFFLG-4"	4"	4 1/2"	6 7/8"		YES				
RFFLG-5"	5"	5 9/16"	7 3/4"		YES				
RFFLG-6"	6"	6 5/8"	8 3/4"		YES				
RFFLG-8"	8"	8 5/8"	11"		YES				
RFFLG-10"	10"	10 3/4"	13 3/8"		YES				
RFFLG-12"	12"	12 3/4"	16 1/8"		YES				
RFFLG-16"	16"	16"	20 1/4"		YES				
RFFLG-18"	18"	18"	21 5/8"		YES				
RFFLG-20"	20"	20"	23 7/8"		AOR				
RFFLG-24"	24"	24"	28 1/4"		AOR				
RFFLG-30"	30"	30"	34 3/4"		AOR				

RFFLG-36"	36"	36"	411/4		AOR				
RFFLG-48"	48"	48"	541/2		AOR				



**Buna-N (Red Rubber Nitrile Gaskets)  
Full Face Flange Gasket 150lb 1/8"THK**

PART#	SIZE	I.D.	O.D.	#Holes	Stock	lbs			
FFFLG-2"-1/8T	2"	23/8"	6"	4	YES				
FFFLG-2 1/2"-1/8T	2 1/2"	27/8"	7"	4	YES				
FFFLG-3"-1/8T	3"	3 1/2"	7 1/2"	8	YES				
FFFLG-4"-1/8T	4"	4 1/2"	9"	8	YES				
FFFLG-5"-1/8T	5"	5 9/16"	10"	8	YES				
FFFLG-6"-1/8T	6"	6 5/8"	11"	8	YES				
FFFLG-8"-1/8T	8"	8 5/8"	13 1/2"	8	YES				
FFFLG-10"-1/8T	10"	10 3/4"	16"	12	YES				
FFFLG-12"-1/8T	12"	12 3/4"	19"	12	YES				
FFFLG-14"-1/8T	14"	14"	21"	12	YES				
FFFLG-16"-1/8T	16"	16"	23 1/2"	16	YES				
FFFLG-18"-1/8T	18"	18"	25"	16	YES				
FFFLG-20"-1/8T	20"	20"	27 1/2"	20	YES				
FFFLG-22"-1/8T	22"	22"	29 1/2"	20	YES				
FFFLG-24"-1/8T	24"	24"	32"	20	YES				
FFFLG-30"-1/8T	30"	30"	38 3/4"	28	YES				
FFFLG-36"-1/8T	36"	36"	46"	32	YES				
FFFLG-48"-1/8T	48"	48"	59 1/2"	44	YES				



**Buna-N (Red Rubber Nitrile Gaskets)  
Ring Face Flange Gasket 150lb 1/8"THK (Drop in) for Weld on flanges**

PART#	SIZE	I.D.	O.D.		Stock	lbs			
RFFLG-2"-1/8T	2"	23/8"	4 1/8"		YES				
RFFLG-2 1/2"-1/8T	2 1/2"	27/8"	4 7/8"		YES				
RFFLG-3"-1/8T	3"	3 1/2"	5 3/8"		YES				
RFFLG-4"-1/8T	4"	4 1/2"	6 7/8"		YES				
RFFLG-5"-1/8T	5"	5 9/16"	7 3/4"		YES				
RFFLG-6"-1/8T	6"	6 5/8"	8 3/4"		YES				
RFFLG-8"-1/8T	8"	8 5/8"	11"		YES				
RFFLG-10"-1/8T	10"	10 3/4"	13 3/8"		YES				
RFFLG-12"-1/8T	12"	12 3/4"	16 1/8"		YES				
RFFLG-14"-1/8T	14"	14"	17 3/4"		YES				
RFFLG-16"-1/8T	16"	16"	20 1/4"		YES				
RFFLG-18"-1/8T	18"	18"	21 5/8"		YES				
RFFLG-20"-1/8T	20"	20"	23 7/8"		AOR				
RFFLG-24"-1/8T	24"	24"	28 1/4"		AOR				
RFFLG-30"-1/8T	30"	30"	34 3/4"		AOR				
RFFLG-36"-1/8T	36"	36"	41 1/4"		AOR				
RFFLG-48"-1/8T	48"	48"	54 1/2"		AOR				

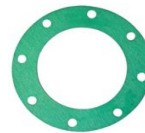
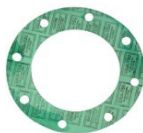

**Non-Abestos Gaskets for easier install  
Full Face Flange Gasket 150lb 1/16"THK**

PART#	SIZE	I.D.	O.D.	#Holes	Stock	lbs			
FFFLG-2"-NA	2"	23/8"	6"	4	YES				
FFFLG-2 1/2"-NA	2 1/2"	27/8"	7"	4	YES				
FFFLG-3"-NA	3"	3 1/2"	7 1/2"	8	YES				
FFFLG-4"-NA	4"	4 1/2"	9"	8	YES				
FFFLG-5"-NA	5"	59/16"	10"	8	YES				
FFFLG-6"-NA	6"	65/8"	11"	8	YES				
FFFLG-8"-NA	8"	85/8"	13 1/2"	8	YES				
FFFLG-10"-NA	10"	103/4"	16"	12	YES				
FFFLG-12"-NA	12"	123/4"	19"	12	YES				
FFFLG-14"-NA	14"	14"	21"	12	YES				
FFFLG-16"-NA	16"	16"	23 1/2"	16	YES				
FFFLG-18"-NA	18"	18"	25"	16	YES				
FFFLG-20"-NA	20"	20"	27 1/2"	20	AOR				
FFFLG-24"-NA	24"	24"	32"	20	AOR				
FFFLG-30"-NA	30"	30"	38 3/4"	28	AOR				
FFFLG-36"-NA	36"	36"	46"	32	AOR				
FFFLG-48"-NA	48"	48"	59 1/2"	44	AOR				



**Non-Abestos Gaskets for easier install.  
Ring Face Flange Gasket 150lb 1/16"THK (Drop in) for Weld on flanges**

PART#	SIZE	I.D.	O.D.		Stock	lbs			
RFFFLG-2"-NA	2"	23/8"	4 1/8"		YES				
RFFFLG-2 1/2"-NA	2 1/2"	27/8"	4 7/8"		YES				
RFFFLG-3"-NA	3"	3 1/2"	5 3/8"		YES				
RFFFLG-4"-NA	4"	4 1/2"	6 7/8"		YES				
RFFFLG-5"-NA	5"	59/16"	7 3/4"		YES				
RFFFLG-6"-NA	6"	65/8"	8 3/4"		YES				
RFFFLG-8"-NA	8"	85/8"	11"		YES				
RFFFLG-10"-NA	10"	103/4"	13 3/8"		YES				
RFFFLG-12"-NA	12"	123/4"	16 1/8"		YES				
RFFFLG-14"-NA	14"	14"	17 3/4"		YES				
RFFFLG-16"-NA	16"	16"	20 1/4"		YES				
RFFFLG-18"-NA	18"	18"	21 5/8"		YES				
RFFFLG-20"-NA	20"	20"	23 7/8"		YES				
RFFFLG-24"-NA	24"	24"	28 1/4"		YES				
RFFFLG-30"-NA	30"	30"	38 3/4"		YES				
RFFFLG-36"-NA	36"	36"	41 1/4"		YES				
RFFFLG-48"-NA	48"	48"	54 1/2"		AOR				



**Non-Abestos Gaskets for easier install  
Full Face Flange Gasket 150lb 1/8"THK**

PART#	SIZE	I.D.	O.D.	#Holes	Stock	lbs			
FFFLG-2"-NA-1/8T	2"	23/8"	6"	4	YES				
FFFLG-2 1/2"-NA-1/8T	2 1/2"	27/8"	7"	4	YES				
FFFLG-3"-NA-1/8T	3"	3 1/2"	7 1/2"	8	YES				
FFFLG-4"-NA-1/8T	4"	4 1/2"	9"	8	YES				
FFFLG-5"-NA-1/8T	5"	59/16"	10"	8	YES				
FFFLG-6"-NA-1/8T	6"	65/8"	11"	8	YES				
FFFLG-8"-NA-1/8T	8"	85/8"	13 1/2"	8	YES				
FFFLG-10"-NA-1/8T	10"	103/4"	16"	12	YES				
FFFLG-12"-NA-1/8T	12"	123/4"	19"	12	YES				
FFFLG-14"-NA-1/8T	14"	14"	21"	12	YES				
FFFLG-16"-NA-1/8T	16"	16"	23 1/2"	16	YES				
FFFLG-18"-NA-1/8T	18"	18"	25"	16	YES				
FFFLG-20"-NA-1/8T	20"	20"	27 1/2"	20	AOR				
FFFLG-24"-NA-1/8T	24"	24"	32"	20	AOR				
FFFLG-30"-NA-1/8T	30"	30"	38 3/4"	28	AOR				
FFFLG-36"-NA-1/8T	36"	36"	46"	32	AOR				
FFFLG-48"-NA-1/8T	48"	48"	59 1/2"	44	AOR				



**Non-Abestos Gaskets for easier install.  
Ring Face Flange Gasket 150lb 1/8"THK (Drop in) for Weld on flanges**

PART#	SIZE	I.D.	O.D.		Stock	lbs			
RFFFLG-2"-NA-1/8T	2"	23/8"	4 1/8"		YES				
RFFFLG-2 1/2"-NA-1/8T	2 1/2"	27/8"	4 7/8"		YES				
RFFFLG-3"-NA-1/8T	3"	3 1/2"	5 3/8"		YES				
RFFFLG-4"-NA-1/8T	4"	4 1/2"	6 7/8"		YES				
RFFFLG-5"-NA-1/8T	5"	59/16"	7 3/4"		YES				
RFFFLG-6"-NA-1/8T	6"	65/8"	8 3/4"		YES				
RFFFLG-8"-NA-1/8T	8"	85/8"	11"		YES				
RFFFLG-10"-NA-1/8T	10"	103/4"	13 3/8"		YES				
RFFFLG-12"-NA-1/8T	12"	123/4"	16 1/8"		YES				
RFFFLG-14"-NA-1/8T	14"	14"	17 3/4"		YES				
RFFFLG-16"-NA-1/8T	16"	16"	20 1/4"		YES				
RFFFLG-18"-NA-1/8T	18"	18"	21 5/8"		YES				
RFFFLG-20"-NA-1/8T	20"	20"	23 7/8"		YES				
RFFFLG-24"-NA-1/8T	24"	24"	28 1/4"		YES				
RFFFLG-30"-NA-1/8T	30"	30"	38 3/4"		YES				
RFFFLG-36"-NA-1/8T	36"	36"	41 1/4"		AOR				
RFFFLG-48"-NA-1/8T	48"	48"	54 1/2"		AOR				



**See our other related Catalogs Grooved fittings & Readyweld coped fittings!**